

SR 3019 SECTION 351 STOCKTON MOUNTAIN ROAD BRIDGE REHABILITATION PROJECT SCHEDULE

- FINAL DESIGN - ONGOING
- ANTICIPATED LETTING DATE -
OCTOBER 2020
- ANTICIPATED START OF CONSTRUCTION -
MARCH 2021
- ANTICIPATED COMPLETION OF CONSTRUCTION -
LATE SPRING / EARLY SUMMER 2021

SR 3019 SECTION 351 STOCKTON MOUNTAIN ROAD BRIDGE REHABILITATION

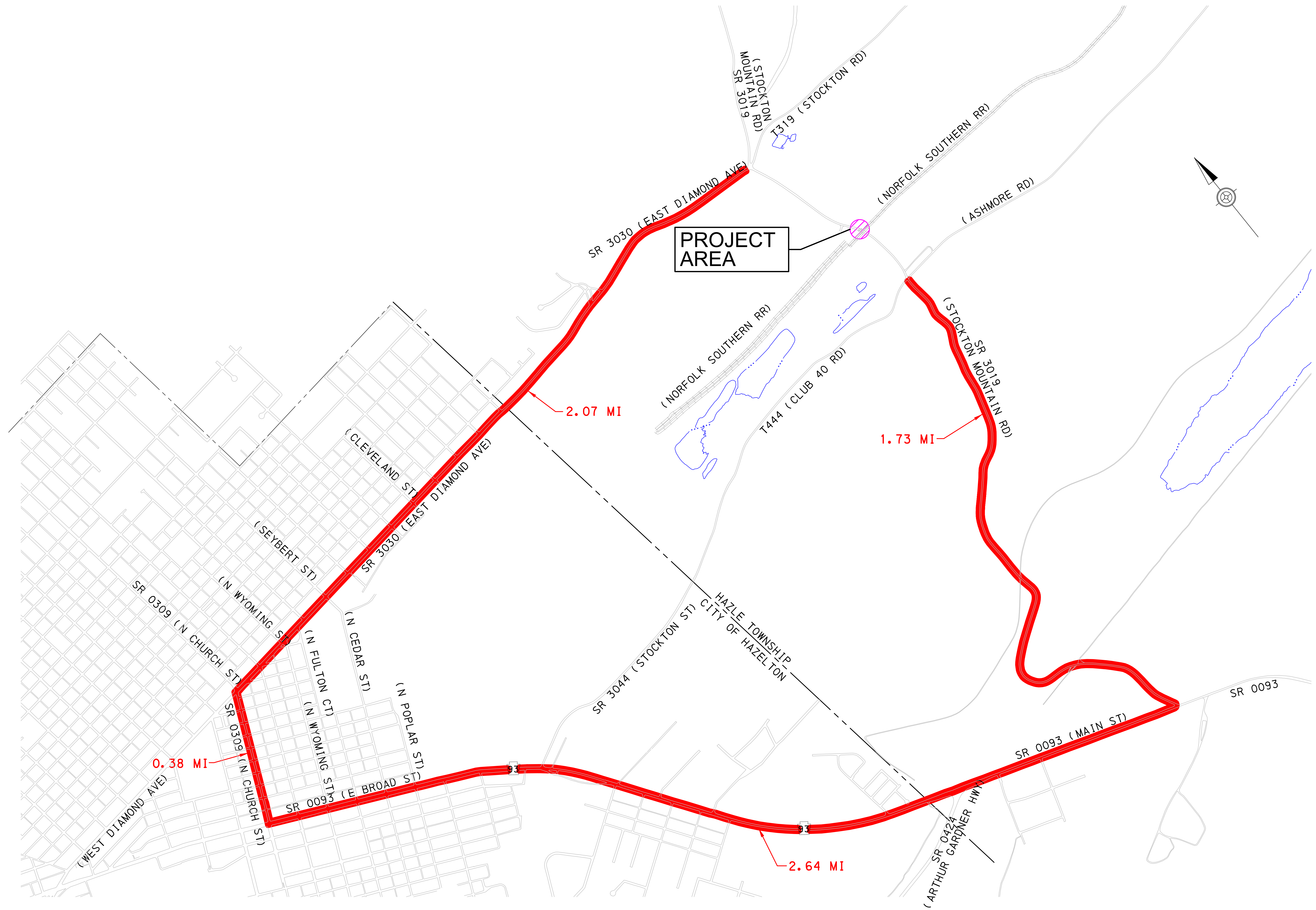

TOTAL DETOUR LENGTH = 6.82 MI

- LEGEND**
- DETOUR ROUTE FOR SR 3019
 - - - TOWNSHIP LINE
 - AREA OF CLOSURE

STAGE 1

CONSTRUCTION DURATION - APPROX. 11 DAYS

0 600 1200 FEET

PRELIMINARY DETOUR PLAN

SR 3019 SECTION 351 STOCKTON MOUNTAIN ROAD BRIDGE REHABILITATION

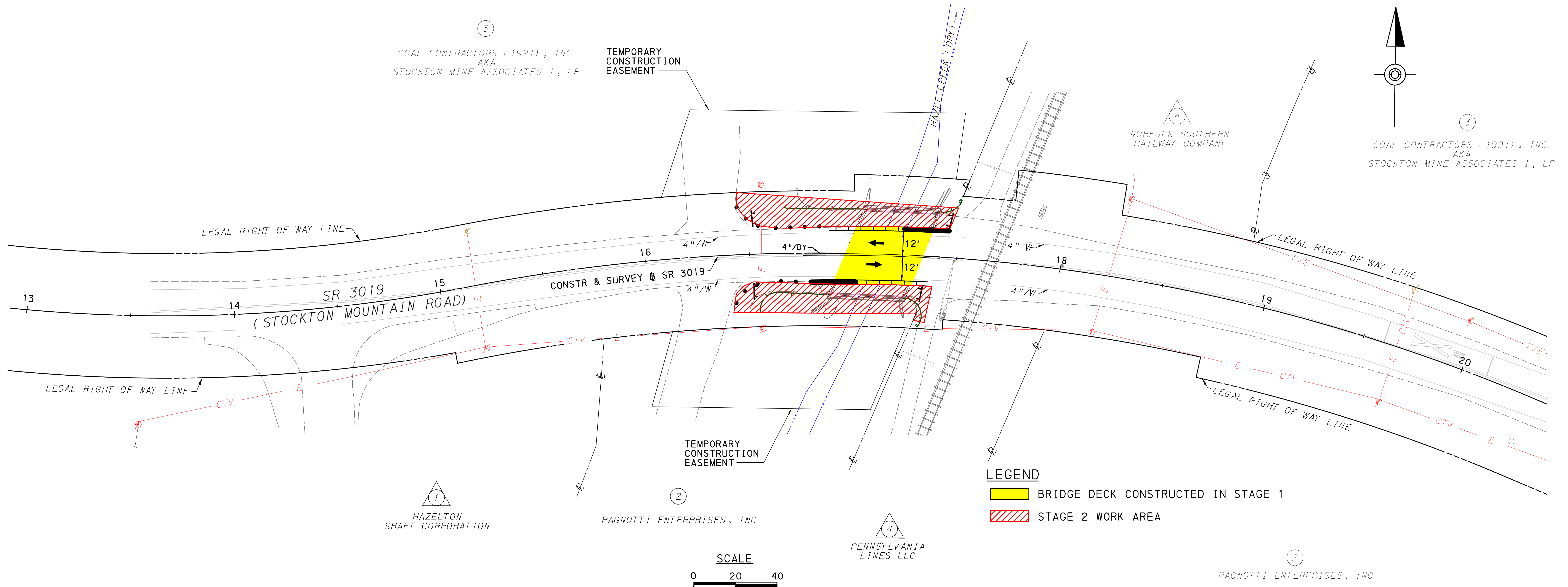

STAGE 2

CONSTRUCTION DURATION - APPROX. 1 MONTH

PRELIMINARY TRAFFIC CONTROL STAGING

SR 3019 SECTION 351 STOCKTON MOUNTAIN ROAD BRIDGE REHABILITATION

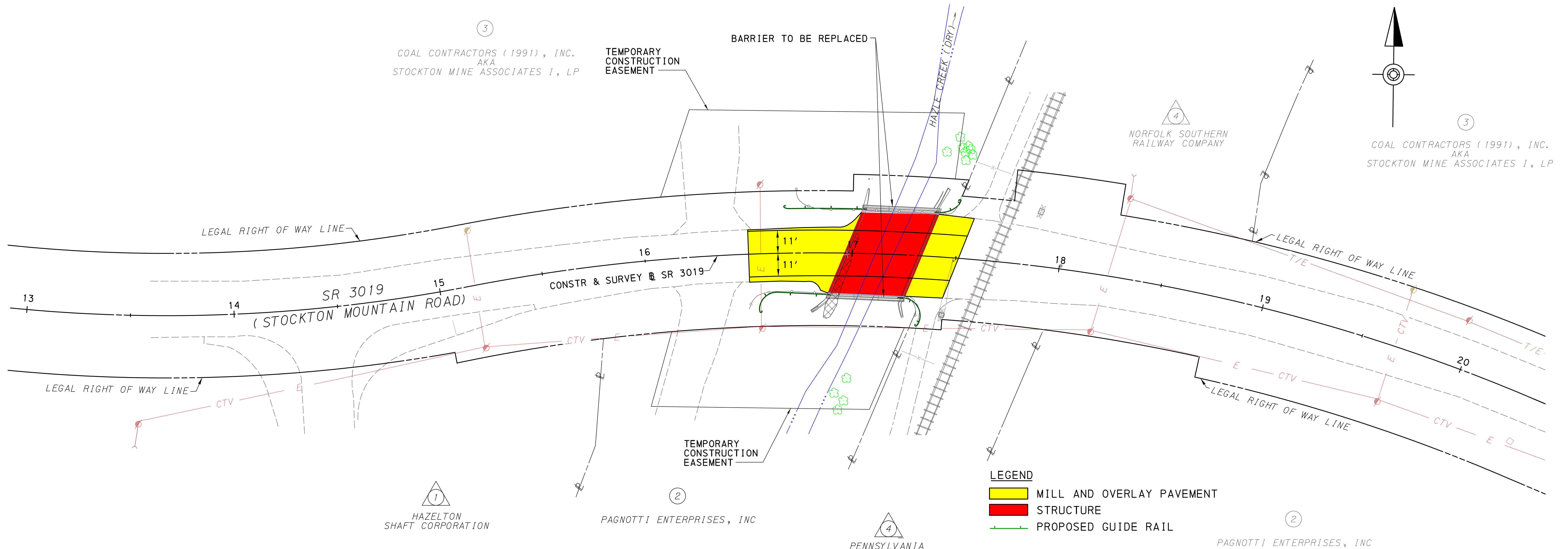

- LEGEND**
- MILL AND OVERLAY PAVEMENT
 - STRUCTURE
 - PROPOSED GUIDE RAIL

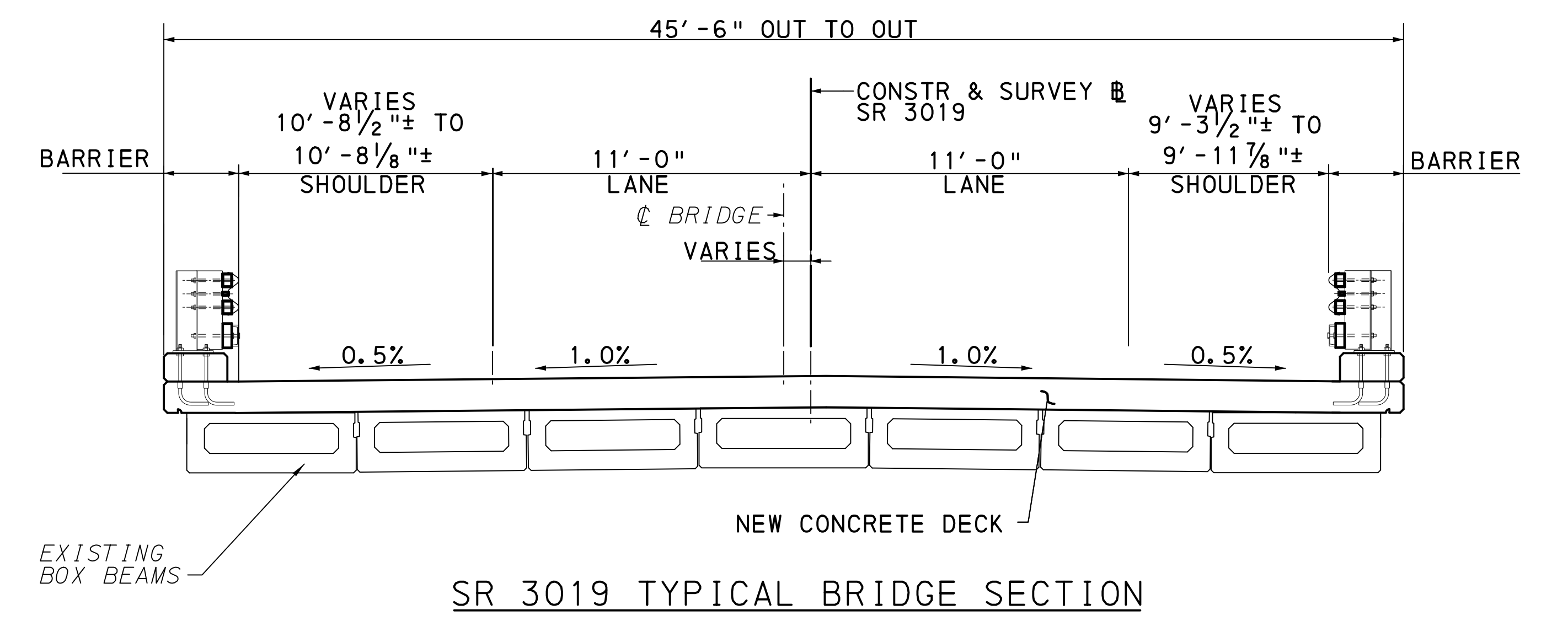
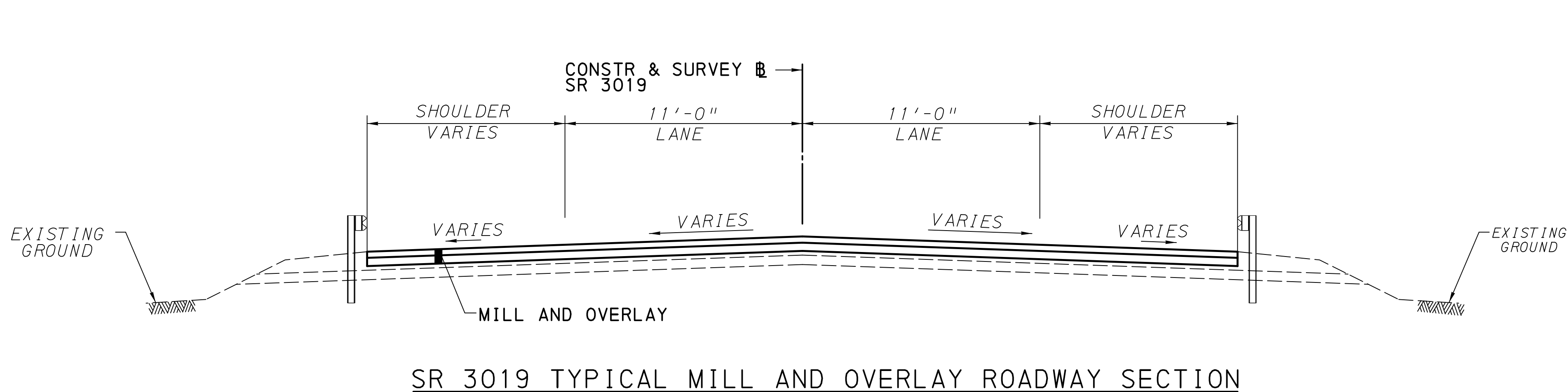
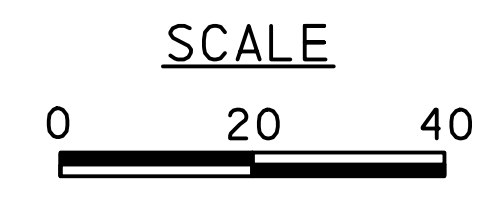

**PRELIMINARY
PLAN & TYPICAL SECTIONS**